

USEF and USDF Licensed #334355 & 334615
Level 2

Opening Date: June 12, 2018
Closing Date: August 1, 2018



Saturday, August 18, 2018 & Sunday, August 19, 2018

Commonwealth Dressage I & II

***Pennsylvania State Farm Show Complex
and Expo Center,
Harrisburg, PA***

Manager:

Barbara Kohr
717-503-6622 (cell)
bakohr@comcast.net

Co-Manager:

Dianne Boyd
703-777-4846 (cell)
greyhorse11@gmail.com

Stable Manager:

Before August 15:
Barbara Kohr
717-503-6622
bakohr@comcast.net

During Show:

Jack Stedding
717-805-0559

Secretary:

Bettina Longaker
8246 Open Gate Road
Gordonsville, VA 22942
540-832-7611
540-301-8166 (fax)
entries@scriptsrides.com

Horse Show Office Phone
Starting Friday, August 19:
717-783-2815

Medical Services:

Melinda Fultz, EMT
George Turnbull, EMT
Located at EMT Station at In
Gate to Large Arena

Competition Licensee:

Commonwealth Equestrian
Productions

Judges:

Debbie Rodriguez, (VA), S
Debbie Savage, (OH), S

Technical Delegate:

Michelle King (VA), r

Veterinarian: On Call,
Green Glen Eq Hosp.,
call 800-245-4312

Farrier: On Call, Scott Eckenrode
717-821-1765

OFFICIAL PRIZELIST. Please check the Commonwealth Dressage website,
<http://www.greyhorse1.com/commonwealth-dressage.html> or facebook,
<https://www.facebook.com/CommonwealthDressage/> for detailed entry information.



Member Shows of the Susquehanna Valley Horse Show Association (SVHSA)

The show is limited to one ring. Enter early to be guaranteed a spot.

Class Descriptions

Sat	Sun	Fee	Description
	20	\$50.00	OPPORTUNITY USDF Intro A (std ring) Open
11	21	\$50.00	OPPORTUNITY USDF Intro B (std ring) Open
12		\$50.00	OPPORTUNITY USDF Intro C (std ring) Open
	23	\$50.00	OPPORTUNITY Training 1 Open
14	24	\$50.00	OPPORTUNITY Training 2 Open
15		\$50.00	OPPORTUNITY Training 3 Open
15	25	\$50.00	OPPORTUNITY First 1 Open
16		\$50.00	OPPORTUNITY First 2 Open
	27	\$50.00	OPPORTUNITY First 3 Open
18	28	\$55.00	USEF Dressage Rider TOC (Training, First, Second) Open
19	29	\$50.00	Dressage Seat Equitation JR/YR/AA
101	201	\$55.00	Training 1 Open
102	202	\$55.00	Training 2 Open/ 2018 CBLM Q
103	203	\$55.00	Training 3 Open/ 2018 GAIG Q
111	211	\$55.00	First 1 Open
112	212	\$55.00	First 2 Open/ 2018 CBLM Q
113	213	\$55.00	First 3 Open/ 2018 GAIG Q
121	221	\$55.00	Second 1 Open
122	222	\$55.00	Second 2 Open/ 2018 CBLM Q
123	223	\$55.00	Second 3 Open/ 2018 GAIG Q
131	231	\$55.00	Third 1 Open
132	232	\$55.00	Third 2 Open/ 2018 CBLM Q
133	233	\$55.00	Third 3 Open/ 2018 GAIG Q
141	241	\$55.00	Fourth 1 Open
142	242	\$55.00	Fourth 2 Open/ 2018 CBLM Q
143	243	\$55.00	Fourth 3 Open/ 2018 GAIG Q
144	244	\$55.00	USEF TOC Open/ 2018 CBLM Q/ 2018 GAIG Q
151	251	\$70.00	FEI Prix. St. Georges Open/ 2018 CBLM Q/ 2018 GAIG Q
152	252	\$70.00	FEI Intermediate I Open/ 2018 CBLM Q/ 2018 GAIG Q
153	253	\$70.00	FEI Intermediate II Open/ 2018 CBLM Q/ 2018 GAIG Q
154	254	\$70.00	FEI Grand Prix Open/ 2018 CBLM Q/ 2018 GAIG Q
155	255	\$70.00	FEI Equivalent TOC(ex. YH,MFS, PE) Open/ 2018 CBLM Q/ 2018 GAIG Q
156###	256###	\$55.00	USDF Training - 4 MFS TOC Open/ 2018 CBLM Q/ 2018 GAIG Q
157	257	\$70.00	FEI Levels MFS TOC Open/ 2018 CBLM Q/ 2018 GAIG Q
158	258	\$50.00	USDF Materiale Fillies/Mares 3, 4, 5 yr old
159	259	\$50.00	USDF Materiale Colts /Stallions/Geldings 3, 4, 5 yr old

No USEF/USDF memberships or Horse ID required for Intro or Opportunity Classes. Opportunity classes also exempt from \$16 USEF fee.

Definitions/Eligibility

CBLM - Qualifying class for 2018 CBLMs. Riders must be members of a participating organization at the time of the show to be eligible.

GAIG - Qualifying class for the 2018 GAIG/USDF Championships (*declare qualifying ride on entry form*) – Entry fee plus additional \$15 fee required, **MUST BE PAID PRIOR TO THE START OF THE CLASS**. Rider and owner must be USDF participating members and USEF members; horse must be USDF Lifetime registered and USEF recorded. Owners may be USDF Business Members. Except for FEI Junior or Young Rider Freestyle entries, competitors in freestyle qualifying classes must submit a photocopy of a test verifying eligibility to enter class.

Open - Open to all Horses and Riders. Show management may split into AA's and Junior/Young Rider sections based on class size

AA - Open to Adult Amateurs only; competitors must compete as adults from the beginning of the calendar year in which they reach the age of 22 & they must hold a current USEF Amateur card.

JR - Open to Junior riders only; ages 18 and under in the current year.

YR – Open to Young riders only; ages 16 through 21 in the current year.

JR/ YR – Open to Juniors and Young riders only; Individuals are eligible as JR until the end of the calendar year in which they reach 18 or YR until the end of the calendar year in which they reach 21 (*specify on entry form*).

TOC - Test of Choice (*specify test level on entry form*). May ride any test that does not have a specific class. *May be qualifier if proper test ridden and fees paid.*

MFS – USDF or FEI Musical Freestyle only; no Pas de Deux or Quadrille.

Materiale - Judged under saddle as a group at walk, trot and canter according to criteria listed on the “USDF Materiale Class” score sheet. Horses must be at least 36 months of age to participate.

* Excludes Young Horse, MFS, and Para-Equestrian tests.

USDF Training MFS is not eligible as a USDF/GAIG qualifier.

PRIZE LIST DIRECTIVES

General:

- EVERY CLASS OFFERED HEREIN WHICH IS COVERED BY THE RULES AND SPECIFICATIONS OF THE CURRENT USEF RULE BOOK WILL BE CONDUCTED AND JUDGED IN ACCORDANCE THEREWITH.
- US EQUESTRIAN FEDERATION rules are in force from the moment show management allows access to the showgrounds. This includes conduct, correct saddlery and equipment, and attire.
- Management reserves the right to split, combine, delete, or add classes dependent on entries. Management also reserves the right to add or substitute judges or make any changes required by circumstances.
- All “No Shows” that have not contacted the show office will be considered a scratch for the rest of the show and time slots may be filled. Exhibitors enter with this understanding and agreement.
- **DOGS MUST BE ON LEASHES AT ALL TIMES WHILE ON SHOW GROUNDS OR IN STABLE AREAS. PENALTIES WILL APPLY IN ACCORDANCE WITH USEF GR1301.6.**

Headgear Rule for Dressage:

- **Anyone mounted on a horse must wear protective headgear that meets ATSM standards. NO EXCEPTIONS. Per USEF DR120.6**

Levels:

- Current editions of all tests/scoresheets: USEF Training-FEI Levels, USDF/FEI Freestyles (TR-FEI Levels), USDF Pas de Deux, Introductory, and Materiale, USEF Rider Tests, USEF/FEI Young Horse, FEI ParaEquestrian, USEF Dressage Seat Equitation, Materiale, USEF Eventing Dressage and FEI Eventing Dressage tests.

Awards:

- Ribbons for First through Sixth place will be awarded for all classes. Prize for each First place.
- Separate awards for Open, AAs and/or Jr/Yrs in any Dressage Open class with four or more in any division. All divisions (if specifically offered) pinned separately. Exception: Open, GAIG/USDF Qualifying & CBLM scored & pinned together.

- **Show High Score Awards:** Ribbons will be given for each of the following: Training, First, Second, Third, Fourth Levels; Combined FEI levels (PSG, I1, I2, IA, IB, I2 and GP); Musical Freestyle. Special ribbons and prizes will be given for the overall high score JR/YR, Adult Amateur (must submit a copy of USEF Amateur card with entry), and Open competitors. Young Horse, Rider Tests, Equitation, Materiale and Musical Freestyle (except for MFS specific award) are excluded from High Score Award calculations. Scores below 55% will not be considered for high score awards.

Entries:

- Current 2018 Entry Forms Required. Entries may be limited if numbers exceed capacity of the facility. Entries received after show is full will be placed on a waiting list. SHOW MAY FILL PRIOR TO CLOSING DATE.
- Please include a valid, **LEGIBLE** e-mail address. All correspondence will be through e-mail.
- **On-Line Entries** may be processed through www.horseshowoffice.com. Payment may be made by electronic check. A 2% convenience fee will apply. Individuals utilizing the online entry system for this competition do so with the agreement that they have read the **OFFICIAL PRIZE LIST** and agree to follow all the class specifications, requirements and conditions in the **OFFICIAL PRIZE LIST**.
- **Payment:** Fees must be paid in full with entry. Payment may be made by check or electronic check (on-line entries). If full payment is not received or a payment for entry fees is returned, the entry will be placed on a waiting list until all fees are paid in cash, money order, or cashier's check. During the show, payment may be made by credit card or check for any additional charges and feed/bedding orders. A 2% convenience fee will apply for credit card transactions.
- Entries accepted ONLY with entry form and full payment. Entry form must be signed in ALL THREE signature blocks in accordance with USEF rules, as well as signature in COACH block if applicable. Only original signatures accepted.
- **ENTRIES MUST BE RECEIVED BY THE SECRETARY BY THE CLOSING DATE. LATE FEE OF \$50.00 WILL BE ASSESSED FOR ANY ENTRY RECEIVED AFTER THE CLOSING DATE.**
- Proof of membership must be included with entry form. Please provide the Master Verification from USEF & USDF (www.eqverification.org) although membership cards or photocopies of cards are still acceptable. Failure to provide proof of USEF and/or USDF membership or affidavit will result in competitor being charged non-member fees.
- Show management reserves the right to refuse entries, make changes, deletions, or corrections as deemed necessary.
- **Negative Coggins** valid through the last day of the show is required for entry to show grounds for all horses. Entries without a current Coggins (valid through show date) WILL NOT BE ACCEPTED. A photocopy is acceptable provided the date, results, horse name, and vet signature are legible.
- Horses entering the show grounds must be accompanied by documentation of **Equine Influenza Virus and Equine Herpes Virus (Rhinopneumonitis) vaccinations** within 6 months prior to entering the show grounds. Horses not in compliance with this rule may be required to leave the grounds upon request by Competition Management (GR845).
- DO NOT send entries registered, certified mail, or Signature required. No telephone, FAX, or email entries.
- Post entries (**received after the closing date**) will be accepted on a space available basis. Must include \$50.00 Late Fee.

Entry Status and Times:

- Acknowledgement of entry showing status will be emailed to each competitor. Please be sure to include a valid, legible e-mail. Please check for errors and notify the secretary immediately.
- Official times posted by noon on Friday at show office. Unofficial times posted on website approximately four days before show.

Fees:

\$225.00 Horse Stall, weekend includes 7 bags of initial bedding \$450.00 Double Horse Stall, weekend includes 14 bags of initial bedding \$150.00 Tack Stall, weekend (no bedding) \$50.00 Electricity Charge per outlet used \$50.00 Grounds Fee (per day/for all horses not stabled) \$25.00 Office Fee, per show for entries received by July 25 (non-refundable) \$35.00 Office Fee, per show for entries received after July 25 until August 1 (non-refundable) \$50.00 Office Fee for single show (non-refundable)	\$45.00 USEF Show Pass(non-member) fee \$35.00 USDF non-member fee \$23.00 USEF Drugs&Meds/horse (excludes Opportunity entrants only) \$15.00 GAIG/USDF Qualifying rides - additional fee \$50.00 Non-competing horse (must also pay Office Fee and grounds fee or stabling, but not USEF Fees) \$10.00 class change fee (during show) \$30.00 Return Check Fee \$50.00 Late Fee (non-refundable, after close date) 2% credit card convenience fee
---	--

- Make checks payable to: **Commonwealth Equestrian Productions.**
- **Return Check Policy:** Entry will be removed from the schedule, charged the return check fee and placed on the Wait List until a money order or certified check is received by the Secretary.
- Show office will be open: Noon -- 7pm Friday, 7am -- 6pm Saturday, 7am -- 1 hour after show ends on Sunday.

Refunds:

- **Until closing date, refunds on entries minus Office Fee.**
- **NO REFUNDS after closing date, including stabling and overpayments, for any reason including cancellations due to Acts of God, acts of terrorism, inclement weather, and/or other emergencies.**
- GAIG/USDF Q fees refunded if request received before start of class until end of competition (unless applied to other indebtedness); otherwise will be paid to USDF.

Freestyle Requirements:

Riders must submit with their entry a copy of the highest test of the level entered or higher level (with a minimum score of 60%) in accordance with USEF rules.

Riders must present music on good quality CD's to the Show Secretary at least 2 hours prior to scheduled time for the ride.

Times for sound checks will be announced at the show. Please check in the show office.

ATTENTION FREESTYLE COMPETITORS



UNITED STATES DRESSAGE FEDERATION™ Freestyle Competitor Reminders

- Submit two CDs of your music clearly labeled with your name, horse's name, bridle number, and freestyle level.
- Be present for your sound check.
- Know the rules for the level you are riding. This includes forbidden and allowed movements for your level.

Questions?

Contact freestyle@usdf.org

4051 IRON WORKS PARKWAY, LEXINGTON, KY 40511 PHONE (859) 971 2277 • FAX (859) 971 7722

Stabling:

- All stall are indoors, on concrete with temporary vinyl walls, 10x10 with doors, housed in permanent buildings.
- Exhibitors wishing to use rubber matting must take it with them when they leave.
- For security reasons, adequate lighting will remain on throughout the night. The facility is in an urban area.
- No hand walking past 9pm.
- No advance stall placement requests can be accommodated other than "stable with" requests.

- Horse stalls are \$225.00 (includes 7 bags of initial bedding) and tack stalls are \$150.00. Stalls available from 10:00AM on Friday and must be vacated Sunday night. NO REFUNDS for stabling for any reason.
- **SHAVINGS PRE-ORDER:** Additional shavings may be pre-ordered at \$9/bag, delivered. Please include your shavings pre-order and payment on your entry. Hay is available at \$12/bale.
- **GROUND FEE:** \$50.00 per day for each horse not stabled during the show.
- Competitors must contact the Stable Manager to arrange early or late arrivals, and may be responsible for additional security or fees associated with their early arrival. Stall assignments will be posted at entrance and show office.
- 24 hour security provided Friday through Sunday.
- Each barn has one sharps container per 50 horses available. Competition Management may fine any individual including trainers, owners, exhibitors, or their agents up to \$100 for improper disposal of needles or other sharp disposable instruments.

Competition Arenas:

- One indoor 20 x 60 meter with Equestrian Elite footing installed by DJL Equestrian Services.
- **Warm-Up:**
- Equine Arena (Indoor) 144' x 300' Sand and dirt mix.
- One outdoor arena, 115' x 225' with stone dust footing

Hospitality: Food available on site during show hours.

Accommodations:

Hampton Inn and Suites, Harrisburg North. 717-540-0900

Spring Hill Suites by Marriott, Harrisburg Hershey. 717-540-5100

Directions:

The Farm Show Complex is located at the junction of North Cameron and Maclay Streets, 2300 N. Cameron St., Harrisburg, PA 17101.

Long Island, NY: Merge onto I 295 North via Exit 33 towards Bronx/New England. I-295 North becomes I-95 South. Follow I-95 S Express Lanes toward I-80. Remain on I-95 South to I-78 West. Follow I-78 toward Harrisburg. Exit I-81 South onto Cameron Street and follow signs to Farm Show Complex. Approx. 195 miles from Great Neck, NY.

New York, NY: Holland Tunnel to 14th Street becomes US-1 and 9/US-9S/US-1S. Take I-78 West express toward Garden State Parkway. Merge onto I-81S. Exit I-81 South onto Cameron Street and follow signs to Farm Show Complex. Approx. 170 miles.

Philadelphia, PA: West on I-76 toward Valley Forge. Merge onto I-283N via Exit 257 toward Harrisburg/Hershey. I-283 N becomes I-83N/US-322W. Merge onto I-81S. Exit I-81 South onto Cameron Street and follow signs to Farm Show Complex. Approx. 110 miles.

Scranton, PA: Follow I-81S to Cameron Street Exit and follow signs to Farm Show Complex.

Hold Harmless Clause

- The Equine Activity Liability laws of Pennsylvania, PA Code SB 618 state among its statutory provisions that , "NOTICE: Intrinsic dangers in equine activity, include (i) the propensity of equines to behave in ways that may result in injury, harm, or death to persons on or around them; (ii) the unpredictability of an equine's reaction to such things as sounds, sudden movement, and unfamiliar objects, persons, or other animals; (iii) certain hazards such as surface and subsurface conditions; (iv) collisions with other animals or objects; and (v) the potential of a participant acting in a negligent manner that may contribute to injury to the participant or others, such as failing to maintain control over the equine or not acting within the participant's ability." No Participant nor any participant's parent, guardian, or representative shall have or make any claim against or recover from any equine activity sponsor, equine professional, or any other person for injury, loss, damage, or death of the participant resulting from any of the intrinsic dangers of equine activities. It is further understood that each owner, rider, spectator, and other participants assume any and all risks of loss or injury and agrees to hold harmless, regardless of negligent acts or omissions Halcyon Farm LTD, Pennsylvania State Farm Show Complex and Expo Center, USDF, USEF, its instructors, officers, directors, agents, show management, show committee, and all other horse show personnel.

Modified Dress Code for Riders in Opportunity Classes

- Riders in classes and tests at all levels in Level 1 Competitions, and riders in Opportunity classes in Level 2 and Level 3 Competitions, may compete wearing breeches and shirts of any color as permitted in DR120.8. Jackets or vests of any type are allowed but not required and neckwear may be worn only if the rider chooses to compete in a riding jacket. Boots and protective headgear are required as specified in DR120.1-6. USEF DR120.5

Fly Hoods permitted for all classes (indoor, covered and outdoor)

- Fly hoods (ear covers) are permitted for all classes in order to protect horses from insects. The fly hoods should be discreet in color and design and should not cover the horse's eyes. After completion of the test, the rider or his representative is responsible for removing the fly hood to present to the designated ring steward for inspection to ensure that nothing prohibited has been added (for example, ear plugs). Logos in compliance with DR121.1 and manufacturer's logos are permitted. USEF DR121.7

Additional USEF and USDF Requirements:

- For current Great American/USDF Championship requirements, go to www.usdf.org/competitions/competitions-championships/regionals/index.asp
- For current CBLM Championship requirements, go to www.cblm.org
- In accordance with GR1301.7: Minors who do not have a valid driver's license which allows them to operate a motorized vehicle in the state in which they reside will not be permitted to operate a motorized vehicle of any kind, including, but not limited to, golf carts, motorcycles, scooters, or farm utility vehicles, on the competition grounds of licensed competitions. Minors who have a valid temporary license may operate the above described motorized vehicles as long as they are accompanied by an adult with a valid driver's license. **The parent(s), legal guardian(s), or individual who signs the entry blank as a parent or guardian of a minor operating a motorized vehicle in violation of this rule are solely responsible for any damages, claims, losses or actions resulting from that operation.** Violations of this rule will be cause for sanctions against the parent(s), guardian(s) and/or trainer(s) who are responsible for the child committing the offense. Penalties may include exclusion of the child, parent(s), guardian(s), and/or trainer(s) from the competition grounds for the remainder of the competition and charges being filed against any of the above individuals in accordance with Chapter 6. Wheelchairs and other mobility assistance devices for individuals with disabilities are exempt from this rule.
- **USEF MEMBERSHIP STATEMENT (GR901.9)** Life, senior active and junior active members shall be eligible to participate in all classes at Regular Competitions, Eventing Competitions at the Preliminary Level or above and Combined Driving Competitions at the Advanced Level, Dressage, Reining and Vaulting Competitions and Endurance Rides. A nonmember may participate as a handler, rider, driver, owner, lessee, agent, coach or trainer at Regular Competitions, Eventing Competitions, Dressage Competitions, Reining Competitions and Combined Driving Competitions upon payment of a \$30 Show Pass fee. Participants in the following classes are exempted from the Requirements of this rule: 1) leadline; 2) exhibitions; 3) games and races; 4) classes for 4-H members; 5) walk trot (exception: Friesian performance FR218) and academy classes (academy classes are classes limited to horses used regularly in a lesson program); 6) USDF introductory level tests, pas de deux and quadrille classes; 7) NRHA Endorsed Reining Competitions. 8) Opportunity classes, 9) citizens of other nations who have proof, in English, of current membership in good standing of their own National Federation, 10) USEA beginner novice division; and 11) assistant handlers in Dressage Sport Horse Breeding classes.

ATTENTION COMPETITORS: Each competitor is responsible for supplying management with correct association numbers (USDF, United States Equestrian Federation) for horse, owner, rider, and trainer, before the day(s) of the competition. The scores of competitors who fail to supply correct numbers may not be counted toward national awards.

USDF Statement on Animal Welfare

The United States Dressage Federation, Inc. (USDF), a federation of over 100 independent organizations throughout the United States with a membership of nearly 30,000 members, supports the concept of ethical treatment of animals.

Dressage is a classical method of training horses, based upon the horse's natural responses, as carried out in a gradual, planned program during which the horse's athletic abilities are improved in a systematic manner. As a result, the horse becomes capable, comfortable, and responsive in partnership with the rider without the use of force. Dressage competition at various levels of achievement is the ultimate test of the training program to determine whether the desired harmony between horse and rider has been achieved.

The rules pertaining to dressage competition prohibit the use of artificial appliances, training aids, and drugs, which would force the horse to submit. Instead, the emphasis is upon training and a cooperative partnership with the rider. Major competitions are carefully monitored to assure that there is no unnecessary force or harshness displayed.

Unlike other horse sports in which horses enter training at a relatively immature state, dressage training is usually not seriously begun until the horse is three or four. The top levels of achievement require five or more years of progressive training and it is not unusual to see horses in international competition in their late teens. This, in itself, places a premium on good care and soundness throughout the horse's life.

While supporting the concept of animal welfare in its broadest form, the United States Dressage Federation, Inc., also recognizes that it is unrealistic to ascribe human emotions and responses to the horse which in its wild state is a creature of flight, living a hard and precarious existence. Under domestication, the horse is assured of ample food, water, and shelter, as well as protection against infectious diseases and damaging parasites, thus leading a longer and healthier life with a high rate of survival.

As an educational organization, USDF has numerous programs, which teach people how to pursue the accepted, humane training methods. A program of certifying instructors also emphasizes protecting the horse's welfare in pursuit of dressage training.

United States Dressage Federation
4051 Iron Works Parkway, Lexington, KY 40511
Phone: 859-971-2277, Fax: 859-971-7722, usdf@usdf.org, www.usdf.org

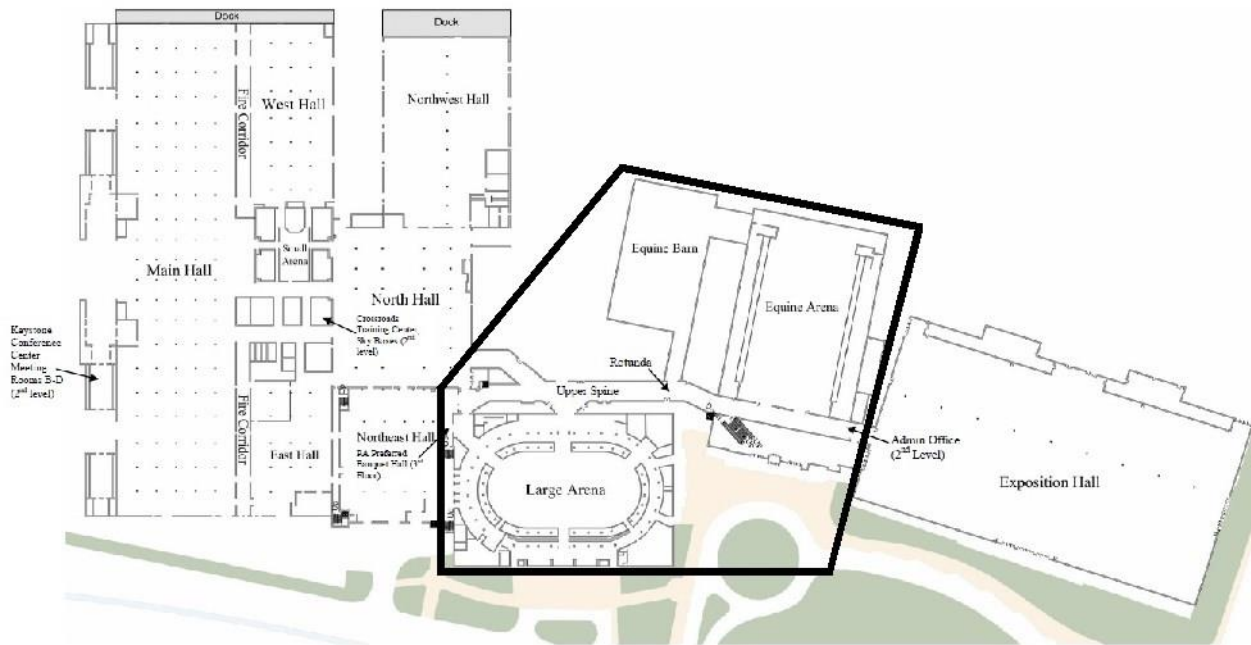

USEF Competition Name:
Competition Division(s) and Rating(s):

USEF#:



WAYS TO SAVE AS A US EQUESTRIAN MEMBER



Save 10% online and in stores

Protect yourself with discounted
liability and AD&D insurance



Save 15% off your first ride
and 5% off all other rides

Buy 10 bags of feed and get one free!



JOHN DEERE

Save up to 28% on equipment like
Gators[™] and lawnmowers

PLUS MANY MORE!



USDF Membership Benefits: USDF is dedicated to education, the recognition of achievement, and promotion of dressage. For details on member benefits, including educational programs, awards, and other opportunities, refer to the *USDF Member Guide* or the USDF website at www.usdf.org.

**This
competition
is recognized
by USDF
for 2018**

Membership Requirements for USEF-licensed/USDF-recognized Competitions: Owners and riders, including foreign riders and owners who are not residents of the US, wishing to participate in a USEF-licensed/USDF-recognized competition as a rider or owner/lessee, must have either a USDF Group Membership (GM), Participating Membership (PM), or have a USDF Non-Member (NM) identification number and pay the USDF Non-Member (NM) fee. (Note: USDF Business Members can own horses but cannot compete as riders with their USDF Business Membership.) Individuals cannot compete at a USEF-licensed/USDF-recognized competition with a USDF Education Membership.

Horses competing at USEF-licensed/USDF-recognized competitions must have either a USDF Horse Identification (HID) number or a USDF Lifetime Horse Registration (LHR). Proper credentials or verification certificates must be presented to the competition secretary.

Riders and owners wishing to participate in a USEF-licensed/USDF-recognized competition, and not able to present the competition secretary with verification of a USDF membership or NM identification, and USDF LHR or USDF HID, must complete a USDF Competition Affidavit Form and pay the \$5 affidavit filing fee. A copy of a completed affidavit form from another competition may also be used for verification purposes for up to 60 days. (Exception: Affidavits cannot be used at Great American Insurance Group/USDF Regional Dressage Championships.)

Exceptions:

- Horses competing only in Individual Breed Classes (IBCs) at DSHB competitions, sires and dams of horses in DSHB group classes, where those sires or dams are not actually competing in the same competition, horses competing only in breed restricted dressage or DSHB classes at Regular Competitions (e.g. all Arabian, all Friesian, or all Morgan classes), or in USDF Introductory Level tests, pas de deux or quadrille, are exempt from this requirement. Also exempt are horses ridden in leadline, exhibitions, games and races, classes for 4-H members, walk-trot, academy, and opportunity classes.
- Riders and owners/lessees competing only in classes which are exempt from the USDF HID requirements are also exempt from the USDF NM identification number and NM fee requirements. Also exempt are handlers of horses competing in DSHB In-Hand or Group classes.

Memberships Defined

Participating Membership (PM): A membership issued to an individual directly by USDF. The membership year is December 1 through November 30. PMs are available for 1-year (\$90), 5-years (\$360), or life (\$1,800). A USDF Youth Participating Membership (YPM) is available for individuals who have not reached their 21st birthday by December 1 of the current membership year (\$72). A PM allows the member to compete at USEF-licensed/USDF-recognized competitions and to participate as a rider and/or owner/lessee for all Adequan®/USDF Year-End Awards, USDF Breeders Championship Series Finals and the Great American Insurance Group/USDF Regional Dressage Championship program.

Group Membership (GM): A membership issued to an individual by USDF when the member name and dues are submitted to USDF through an affiliate Group Member Organization (GMO). The GM year begins December 1 and ends November 30. A GM allows the member to compete at USEF-licensed/USDF-recognized competitions and participate in the USDF Rider Awards program.

Business Membership (BM): A membership that runs December 1 through November 30 and is issued to a business or organization directly by USDF. The USDF BM (\$240) offers a wider variety of advertising benefits. BMs satisfy requirements of horse ownership only.

Education Membership (EM): A membership issued to an individual directly by USDF. This online education only membership expires 12 months after the date joined. This membership type does NOT allow an individual to compete at a USEF-licensed/USDF-recognized competition.

Non-Member (NM) Identification Number: For each USDF NM owner/lessee and USDF NM rider there will be a USDF NM fee of \$35 per competition that must be collected by the show secretary and submitted to USDF, along with the USDF Report of Fees document and the \$5 affidavit fee and Competition Affidavit Form if the person cannot provide a copy of their USDF NM card. Owners/lessees or riders exempt from the NM number requirements are also exempt from paying the USDF NM fee. If there are multiple owners of a horse and all are NMs, only one of the owners must pay the NM fee. If the horse has at least one owner who is a current USDF PM, GM, or BM there is no NM fee assessed. Competition management will be invoiced for all applicable USDF NM fees not received with the USDF post-competition paperwork, along with a report listing all USDF NMs. Competition management is then required to submit the NM fees within 30 days to the USDF. An individual with a USDF NM identification number is not eligible for any USDF membership benefits. Once a USDF NM number has been assigned, a USDF NM card can be obtained from the USDF website.

Horse Identification (HID) Number: A one-time tracking number for horses (\$35). Scores earned by a horse with an HID number will be recorded, but will NOT be counted towards Adequan®/USDF Year-End Awards. A horse with an HID number is not eligible to compete in Great American Insurance Group/USDF Regional qualifying or championship classes or USDF Breeders Championship Series Finals. An HID number can be upgraded to a Lifetime Horse Registration (LHR) for a fee of \$80. If a horse has a USDF LHR it does not need an HID number. An HID number is a one-time fee that does not need to be renewed.

Lifetime Horse Registration (LHR): A horse with an LHR (\$115) is eligible for Adequan®/USDF Year-End Awards, and eligible to compete at USDF Breeders Championship Series Finals and Great American Insurance Group/USDF Regional qualifying and championship classes, assuming requirements for the owner and rider are met. If a horse has an LHR it does not need an HID number. An LHR does not need to be renewed.

How to Join USDF

Applications for USDF Participating Membership (PM), Business Membership (BM), Horse Identification (HID) number, and Lifetime Horse Registration (LHR) may be found in the following locations:

- On the USDF website: www.usdf.org. You can submit the application online or download the form and fax or mail it to the USDF office.
- In the show office at USEF-licensed/USDF-recognized competitions classified by USEF as Dressage Competitions, and Regular Competitions which are open to all breeds.
- By calling or writing the USDF office at (859) 971-2277, 4051 Iron Works Parkway, Lexington, KY 40511

The effective date of membership is the date the form and correct fees are received in the USDF office or, if applying at a competition, the date accepted by the competition secretary, provided the application is signed and dated by the competition secretary, member, and/or horse owner on that same day.



2018 Great American Insurance Group/USDF Regional Dressage Championships

A single Regional Dressage Championship program organized by the United States Dressage Federation (USDF), and recognized by the United States Equestrian Federation, Inc. (USEF), will be held in each of the nine USDF regions. In addition, Alaska and Hawaii may each hold state championships if an official request from a Group Member Organization (GMO) is received by April 1 of the prior year. The Regional Championship Program Rules can be found on the USDF website at www.usdf.org. Please refer to the 2018 USDF Member Guide for the comprehensive list of rules and requirements for this program.

Membership/Registration Requirements for Qualifying and Championships

All memberships and registrations/recordings must be correct and current at the time qualifying scores are earned and at the time of the championships.

Rider:

- Must have a USDF Participating* Membership (PM).
- Must have a USEF membership (Junior Active, Senior Active, or Life).

Horse:

- Must have a USDF Lifetime Horse Registration (LHR).
- Must have a USEF (Annual or Lifetime) Horse recording.
- USDF horse registration and USEF horse recording must be in the name(s) of the current owner(s) or lessee(s) of record. A horse is not required to have breed registry papers.

Owner:

- Must have a USDF Participating or Business Membership and a USEF membership (Junior Active, Senior Active, Life, or Recorded Farm (with Active Farm Owner)). If the horse has more than one owner, at least one owner must have both active USEF membership and active USDF Participating or Business Membership. For a business or farm to be the valid owner under this requirement, it must be listed as an owner of the horse with both USEF and USDF.

* PMs are USDF members who join USDF directly. USDF Group Members (GM) are ineligible.

Minimum Qualifying Scores: One set of nationally-standardized qualifying scores has been established for all USEF/USDF Regional Championships, for Training Level through Grand Prix, in three divisions: open, adult amateur and junior/young rider. FEI Junior and FEI Young Rider classes have only one respective division. Freestyles have only open divisions.

The minimum percentages are as follows:

	OPEN	AA	JR/YR
Training Level (Test 3)	68%	63%	63%
First Level (Test 3)	66%	62%	62%
Second Level (Test 3)	64%	61%	61%
Third Level (Test 3)	62%	60%	60%
Fourth Level (Test 3)	62%	60%	60%
FEI Junior (Team Test)	—	—	60%
FEI Young Rider (Team Test)	—	—	60%
Prix St. Georges	60%	60%	60%
Intermediate I	60%	60%	60%
Intermediate II	60%	60%	60%
Grand Prix	60%	60%	60%
FREESTYLE	OPEN	AA	JR/YR
First Level	63%	—	—
Second Level	63%	—	—
Third Level	63%	—	—
Fourth Level	63%	—	—
Intermediate I	63%	—	—
Grand Prix	63%	—	—



UNITED STATES DRESSAGE FEDERATION™

Regional Adult Amateur Equitation Program

The USDF Regional Adult Amateur Equitation Program recognizes adult amateurs competing in equitation and promotes correct seat, position, and use of the aids in dressage. An Adult Amateur Equitation Regional Final class will be held in conjunction with each of the nine USDF Regional Dressage Championship competitions, providing adult amateurs with additional opportunity for recognition.

Adult amateurs wishing to qualify to compete in an Adult Amateur Equitation Regional Final may do so by meeting the following requirements.

Qualifying Requirements

To be eligible for the USDF Adult Amateur Equitation Regional Final class, rider must have

- a) Earned a score of 70% or higher in any dressage seat equitation class (except walk/trot) at a USEF/USDF-recognized Dressage competition within the qualifying period of the applicable regional championship.
- or*
- b) Qualified to compete in any regional dressage championship class (excluding freestyles).

Membership Requirements

- Rider must have a USDF Participating Membership at the time the qualifying score is earned, and at the time of the Regional Final class.
- Rider must be an adult amateur, in accordance with GR1306 of the USEF rules, and be designated with USEF as an adult amateur when the score is earned, and at the time of the Regional Final class.
- Owner must have a USDF Participating or Business Membership when the qualifying score is earned, and at the time of the Regional Final class.
- Horse must have a USDF Lifetime Horse Registration when the qualifying score is earned, and at the time of the Regional Final class.

The USDF Regional Adult Amateur Equitation Program rules and information can be found on the USDF [website](#).

2018 DRESSAGE COMPETITION ENTRY FORM

Effective December 1, 2017, use this form for entering USEF/USDF Licensed Dressage

Competitions held in USDF Region 1 (PA, NJ, DE, MD, VA, NC, WV)

Competitors are responsible for duplicating their own additional copies of this entry form. This is a 2-sided form; please make 2-sided copies. Other versions of entry forms may not be accepted by Region 1 competitions. **TYPE OR PRINT CLEARLY -- ONLY ONE HORSE / RIDER or HANDLER PER ENTRY FORM**

Enclose copy of all 2018 USEF Membership Cards (Rider/Handler, Owner/Agent, Trainer, Coach) or verification.

Official Use Only

Bridle No.

Competition Name: _____ Competition Date(s): _____

NAME OF HORSE (Horse MUST be named)	BREED	COUNTRY (Where Bred)	SEX	HEIGHT	COLOR	AGE	DOB
Date of Coggins (must attach copy):	Breed Registration Number:			Check here if this horse is for sale and you want this to be listed in the Program _____			
Sire:	Dam:			Dam's Sire:			
For Dressage Sport Horse Breeding (DSHB) classes, Sire, Dam, Dam's Sire & Breeder names required for ALL breed registered horses & recommended for others.				Breeder:			

Rider/Handler: _____ Primary Phone: _____ Alternate Phone: _____

Rider's Address: _____

Rider/Handler E-Mail: _____ Citizenship*: _____

Owner: _____ Primary Phone: _____ Alternate Phone: _____

Owner's Address: _____ E-Mail: _____

Trainer: _____ Trainer's Address: _____

Coach: _____ Trainer's Phone during Competition: _____

HORSE	RIDER/HANDLER	OWNER (At least one)	TRAINER	COACH (if applicable)
USEF#	USEF#	USEF#	USEF#	USEF#
USDF#	USDF#	USDF#		
LOCAL ASSN #		All USEF members (including riders, handlers, trainers, coaches, owners, agents or lessees) are required to submit proper membership documentation to the show secretary prior to competing. Exhibitors who do not send a copy of their card with their entry or are unable to produce the card when registering at the competition, or for whom the competition cannot verify such information (with the exception of Federation measurement cards) will be required to pay a \$45 Show Pass fee which is non-refundable. EACH Junior and Senior participant (rider, handler, trainer, coach and one owner/agent per horse) is required to be a USEF Active "Competing" Member or pay a \$45 Show Pass fee (see the official USEF Show Pass Statement in prize list). Non-U.S. citizen participants in Dressage/DSHB classes MUST attach current proof, in English, of current membership in good standing in their own N.F. in order to be exempt from USEF Show Pass fees.		
Unless show provides entry verification service: * MUST attach copies of USEF & USDF Horse Recording and Registration Certificates for GAIG/USDF Qualifying and Championship Classes. * MUST include a copy of USEF Amateur Certification if competing as an Adult Amateur. Go to http://www.eqverification.org/ to print copies.				

Class #	Day	Class Name (Level//Division/Test - if TOC)	GAIG Fee	Fee	Payment For	Fee	Office Use
					Subtotal, Class Fees		
					USEF Show Pass/Non-Member Fee(s) (\$45 per participant)		
					USEF Fee per horse: (D&M \$15+ USEF \$8) = \$23		
					CDI horses only: USEF Fee per horse: (D&M \$25 + USEF \$8) = \$33		
					CDIs only: USEF IHP Discipline Fee (\$35 per entry)		
					Stabling / Grounds Fee (For Non-Stabled Horses)		
					USDF Non-Member Fee(s) (\$35 per rider/owner)		
					Office Fee		
					Late Fee, Bridle Number Fee, Camper Fee		
					Other Fee(s)		
SUBTOTAL Class Fees							

JR or YR Birthdate: _____ Riders are eligible to compete as a Jr/YR until the end of the calendar year in which they reach the age of 21

TOTAL FEES DUE:

CDI / CDI-YI / CDI-J / CDI-P COMPETITORS MUST COMPLETE THE FOLLOWING INFORMATION:			
Rider:	Citizenship:	FEI Rider Registration #:	Competing for Country:
Horse:	Present Nationality:	Birthdate:	Previous Name (if any):
	FEI Passport #:	FEI Horse Registration #:	Person Responsible:
Owner:	Citizenship:	Owner Social Security or Tax ID # (required to receive prize money):	

US Equestrian Federation, Inc. Entry Agreement I have read the United States Equestrian Federation, Inc. (the "Federation") Entry Agreement (GR906.4) as printed in the Prize List for [insert name here] ("Competition") and agree to all of its provisions. I understand and agree that by entering this Competition, I am subject to Federation Rules, the Prize List, and local rules of the competition. I agree to waive the right to the use of my photos at the competition, and agree that any actions against the Federation must be brought in New York State.

Federation Release, Assumption of Risk, Waiver and Indemnification *This document waives important legal rights. Read it carefully before signing.* I AGREE in consideration for my participation in this Competition to the following:

I AGREE that the "Federation" and "Competition" as used herein includes the Licensee and Competition Management, as well as all of their officials, officers, directors, employees, agents, personnel, volunteers and Federation affiliates. I AGREE that I choose to participate voluntarily in the Competition with my horse, as a rider, driver, handler, vaulter, longeur, lessee, owner, agent, coach, trainer, or as parent or guardian of a junior exhibitor. I am fully aware and acknowledge that horse sports and the Competition involve inherent dangerous risks of accident, loss, and serious bodily injury including broken bones, head injuries, trauma, pain, suffering, or death. ("Harm"). I AGREE to hold harmless and release the Federation and the Competition from all claims for money damages or otherwise for any Harm to me or my horse and for any Harm of any nature caused by me or my horse to others, even if the Harm arises or results, directly or indirectly, from the negligence of the Federation or the Competition. I AGREE to expressly assume all risks of Harm to me or my horse, including Harm resulting from the negligence of the Federation or the Competition. I AGREE to indemnify (that is, to pay any losses, damages, or costs incurred by) the Federation and the Competition and to hold them harmless with respect to claims for Harm to me or my horse, and for claims made by others for any Harm caused by me or my horse while at the Competition. I have read the Federation Rules about protective equipment, including GR801 and, if applicable, EV114, and I understand that I am entitled to wear protective equipment without penalty, and I acknowledge that the Federation strongly encourages me to do so while WARNING that no protective equipment can guard against all injuries. If I am a parent or guardian of a junior exhibitor, I consent to the child's participation and AGREE to all of the above provisions and AGREE to assume all of the obligations of this Release on the child's behalf I represent that I have the requisite training, coaching and abilities to safely compete in this competition. I AGREE that if I am injured at this competition, the medical personnel treating my injuries may provide information on my injury and treatment to the Federation on the official USEF accident/injury report form. BY SIGNING BELOW, I AGREE to be bound by all applicable Federation Rules and all terms and provisions of this entry blank and all terms and provisions of this Prize List. If I am signing and submitting this Agreement electronically, I acknowledge that my electronic signature shall have the same validity, force and effect as if I affixed my signature by my own hand.

*RIDER/HANDLER (mandatory)	*OWNER / AGENT (mandatory)	*TRAINER (mandatory)	COACH (If applicable)
Signature:	Signature:	Signature (must be 18 or older):	Signature:
Print:	Print:	Print:	Print:
PARENT/GUARDIAN (Required if rider/handler is a minor, i.e. under 18)		(Home/Parent) Emergency Contact Phone #	Is RIDER a U.S. citizen? (mandatory)
Signature:	Print:		YES _____ NO _____

* No entry is valid without original signatures from the above individuals; Photocopied signatures or writing "same" are NOT acceptable.

STABLING / CAMPER HOOK-UP RESERVATION FORM (Refer to Prize List for Specifications)									
Contact NAME and NUMBER for Rider Emergency: _____/_____					Contact NAME and NUMBER for Horse Emergency: _____/_____				
Name of Lodgings Where Rider or Responsible Party Will be Staying During the Competition _____					Hotel Number at the Competition (For Emergency Contact Purposes) _____				
Stall Occupant	Sex (S,M,G)	Check Stall Days/Nights Desired (see prize list directives)							
		Mon	Tues	Wed	Thurs	Fri	Sat	Sun	
Horse Name									
If accompanied by NON-COMPETING HORSE, must complete separate entry form and pay all applicable fees.									
Tack	n/a								
Approx. Time of Arrival: _____ Approx. Time of Departure: _____									
Special Requests*: _____									
*Provide name of individual with whom you desire to be stabled (if part of a group, make sure you all name the same person) _____									
Stabling fees: _____ stalls for _____ nights @ \$ _____ per night = _____									
Camper fees _____ hook-ups @ \$ _____ ea (flat rate) OR _____ nights @ \$ _____ per night = _____									
TOTAL STABLING / CAMPER HOOK-UP FEES: _____									

ENTRY PREPARATION CHECKLIST
<i>Before Mailing, Be Sure You Have:</i>
___ Completed Both Sides of Entry Form
___ All Original Required Signatures
___ Enclosed a Copy of the Current Negative Coggins (EIA) Certificate (Refer to Show Specifications for Date Validity Requirements. Copy must be legible.)
___ Supplied all Required Ass'n Numbers
___ Enclosed Copies of Applicable USEF and/or USDF Cards or Documents
___ Completed the Stabling / Camper Vaccination Certificate
___ Enclosed a Check / Money Order for all Applicable Fees.
___ Attached photocopy of Test(s) verifying USDF & FEI Freestyle Test eligibility (ex. for exempt classes)
Mail this Entry Form, Supplemental Documents, and Fees to the Competition (Entry) Secretary Identified on the Prize List.
EMERGENCY CELL CONTACT # OF SOMEONE WITH YOU / YOUR GROUP AT THIS SHOW WHO IS NOT LISTED ELSEWHERE ON THIS ENTRY FORM

FILL OUT ONLY IF THE COMPETITION YOU ENTER ON THIS ENTRY FORM OFFERS CERTAIN USE OF CHARGE CARDS!!
(Check in the prize list or individual competition requirements)

Name on Card: _____ Credit Card #: _____ - _____ - _____
Expiration Date: _____ / _____ ☐ Visa ☐ MasterCard ☐ Discover Card ☐ Other _____ CCV #: _____
Signature: _____ Billing Address: _____ Zip Code: _____

PLEASE SUBMIT ANY IMPORTANT INFORMATION FOR THE ANNOUNCER ON A SEPARATE SHEET